

JST

Crimp

2.5mm
(.098") pitch

NH CONNECTOR

Disconnectable Crimp style connectors

This 2.5mm (.098") pitch connector is used to connect wires to printed circuit boards. The header is available in three configurations : top, side, and bottom entry. This allows the wires to be perpendicular or parallel to the printed circuit board in any direction.

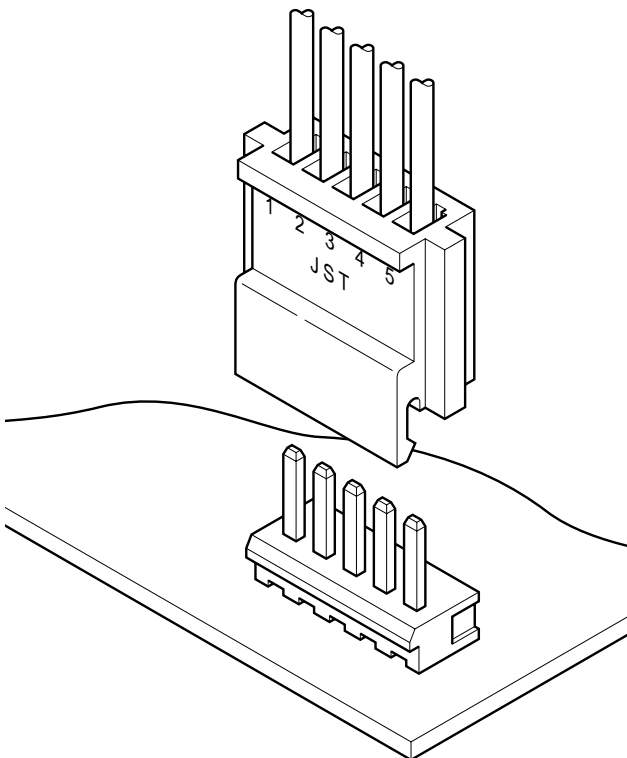

Features

• Superior folded beam construction

- (1) This sturdy construction withstands repeated stress, resists permanent deformation, and offers a very long service life.
- (2) High reliability is ensured whether the contact pressure is high or low.
- (3) This contact design has a large tolerance for variations in mating post thickness and resists deformation when pried.

• Double-sided contact

- (1) The receptacle contact has a protected entry which eliminates contact damage caused by mismatching.
- (2) It provides high contact pressure, is free from abnormal stress, and maintains continuity at all times.
- (3) It has an extremely long service life due to its folded beam design.

• Whisker prevention

The header post is copper-undercoated and tin/lead-plated to prevent whiskers from being generated and to provide good solderability.

• Wide, sturdy post

The post has a large cross-sectional area to resist prying during insertion into printed circuit boards and mating with connector housings.

• Molded-in header

The posts are molded into the insulator to provide stability when mounted on printed circuit boards. This also prevents flux from entering the connector during soldering.

Specifications

- Current rating: 3A AC, DC (AWG#22)
 - Voltage rating: 250V AC, DC
 - Temperature range: -25°C to +85°C
(including temperature rise in applying electrical current)
 - Contact resistance: Initial value/15m max.
After environmental testing/20m max.
 - Insulation resistance: 500M min.
 - Withstanding voltage: 1,500V AC/minute
 - Applicable wire: AWG #30 to #22
 - Applicable PC board thickness: 1.6mm(.063")
- * Contact JST for details.

Standards

 Recognized E60389

 Certified LR20812

 R75086

NH CONNECTOR

Contact

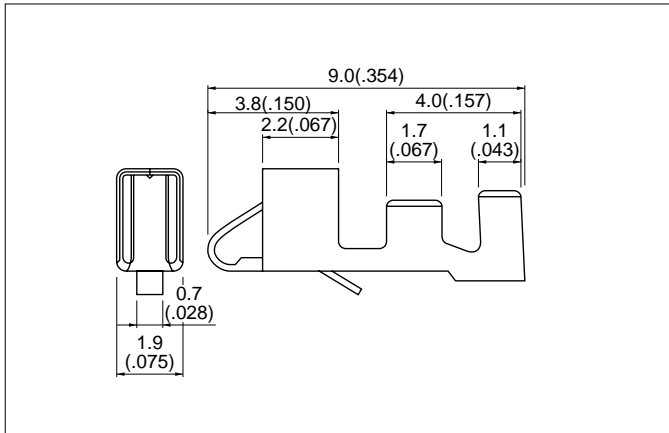

Model No.	Applicable wire			Q'ty / reel
	mm ²	AWG #	Insulation O.D. mm(in.)	
SHF-001T-0.8BS	0.08 to 0.33	28 to 22	1.2 to 1.7 (.047 to .067)	5,000
SHF-002T-0.8BS	0.05 to 0.08	30 to 28	0.9 to 1.2 (.035 to .047)	

Material and Finish

Phosphor bronze, tin-plated

Note:

1. Contact JST if you require gold-plated contacts.
2. Also contact JST if you require shielded wires, thin wires or other special wires.

Housing

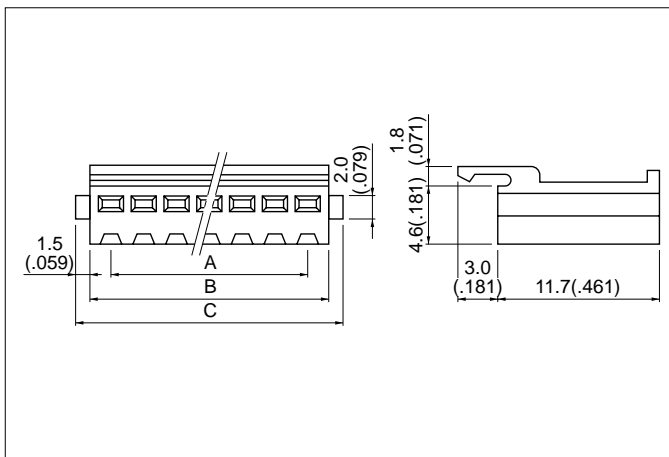

Circuits	Model No.	Dimensions mm(in.)			Q'ty / bag
		A	B	C	
2	H 2P-SHF-AA	2.5(.098)	5.7(.224)	8.7(.343)	1,000
3	H 3P-SHF-AA	5.0(.197)	8.2(.323)	11.2(.441)	1,000
4	H 4P-SHF-AA	7.5(.295)	10.7(.421)	13.7(.539)	1,000
5	H 5P-SHF-AA	10.0(.394)	13.2(.520)	16.2(.638)	1,000
6	H 6P-SHF-AA	12.5(.492)	15.7(.618)	18.7(.736)	1,000
7	H 7P-SHF-AA	15.0(.591)	18.2(.717)	21.2(.835)	500
8	H 8P-SHF-AA	17.5(.689)	20.7(.815)	23.7(.933)	500
9	H 9P-SHF-AA	20.0(.787)	23.2(.913)	26.2(1.031)	500
10	H10P-SHF-AA	22.5(.886)	25.7(1.012)	28.7(1.130)	500
11	H11P-SHF-AA	25.0(.984)	28.2(1.110)	31.2(1.228)	500
12	H12P-SHF-AA	27.5(1.083)	30.7(1.209)	33.7(1.327)	500
13	H13P-SHF-AA	30.0(1.181)	33.2(1.307)	36.2(1.425)	500
14	H14P-SHF-AA	32.5(1.280)	35.7(1.406)	38.7(1.524)	500
15	H15P-SHF-AA	35.0(1.378)	38.2(1.504)	41.2(1.622)	200
16	H16P-SHF-AA	37.5(1.476)	40.7(1.602)	43.7(1.720)	200
18	H18P-SHF-AA	42.5(1.673)	45.7(1.799)	48.7(1.917)	200
20	H20P-SHF-AA	47.5(1.870)	50.7(1.996)	53.7(2.114)	200
21	H21P-SHF-AA	50.0(1.969)	53.2(2.094)	56.2(2.213)	200
22	H22P-SHF-AA	52.5(2.067)	55.7(2.193)	58.7(2.311)	200
24	H24P-SHF-AA	57.5(2.264)	60.7(2.390)	63.7(2.508)	200
25	H25P-SHF-AA	60.0(2.363)	63.2(2.488)	66.2(2.606)	200

Material

Nylon 6, UL94V-0, natural (white)

<For reference> As the color identification, the following alphabet shall be put in the underlined part. For availability, delivery and minimum order quantity, contact JST.

ex. H2P-SHF-AA-00
 (blank)...natural (white)
 K...black R...red TR...tomato red E...blue M...green
 O...orange N...brown

Header

Top entry type

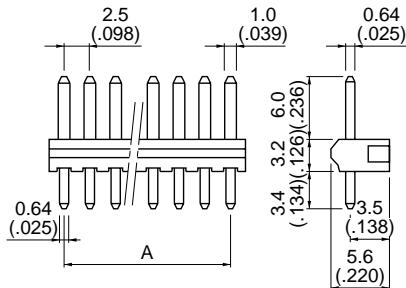

Side entry type

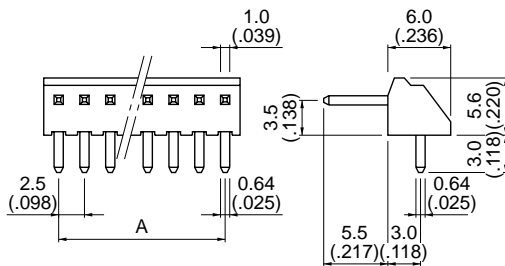

Bottom entry type

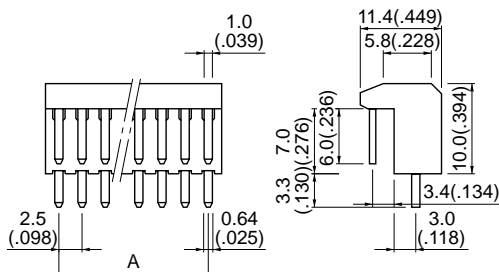

Circuits	Model No.			Dimensions A mm(in.)	Q'ty / box		
	Top entry type	Side entry type	Bottom entry type		Top entry type	Side entry type	Bottom entry type
2	B 2P-SHF-1AA	BS 2P-SHF-1AA	BE 2P-SHF-1AA	2.5(.098)	1,000	2,000	250
3	B 3P-SHF-1AA	BS 3P-SHF-1AA	BE 3P-SHF-1AA	5.0(.197)	1,000	1,000	250
4	B 4P-SHF-1AA	BS 4P-SHF-1AA	BE 4P-SHF-1AA	7.5(.295)	1,000	1,000	250
5	B 5P-SHF-1AA	BS 5P-SHF-1AA	BE 5P-SHF-1AA	10.0(.394)	1,000	500	250
6	B 6P-SHF-1AA	BS 6P-SHF-1AA	BE 6P-SHF-1AA	12.5(.492)	1,000	500	150
7	B 7P-SHF-1AA	BS 7P-SHF-1AA	BE 7P-SHF-1AA	15.0(.591)	500	500	150
8	B 8P-SHF-1AA	BS 8P-SHF-1AA	BE 8P-SHF-1AA	17.5(.689)	500	500	150
9	B 9P-SHF-1AA	BS 9P-SHF-1AA	BE 9P-SHF-1AA	20.0(.787)	500	500	150
10	B10P-SHF-1AA	BS10P-SHF-1AA	BE10P-SHF-1AA	22.5(.886)	500	250	100
11	B11P-SHF-1AA	BS11P-SHF-1AA	BE11P-SHF-1AA	25.0(.984)	500	250	100
12	B12P-SHF-1AA	BS12P-SHF-1AA	BE12P-SHF-1AA	27.5(1.083)	250	200	100
13	B13P-SHF-1AA	BS13P-SHF-1AA	BE13P-SHF-1AA	30.0(1.181)	250	200	100
14	B14P-SHF-1AA	BS14P-SHF-1AA	BE14P-SHF-1AA	32.5(1.280)	250	200	50
15	B15P-SHF-1AA	BS15P-SHF-1AA	BE15P-SHF-1AA	35.0(1.378)	250	200	50
16	B16P-SHF-1AA	BS16P-SHF-1AA	—	37.5(1.476)	250	200	—
18	B18P-SHF-1AA	BS18P-SHF-1AA	—	42.5(1.673)	250	200	—
20	B20P-SHF-1AA	BS20P-SHF-1AA	—	47.5(1.870)	250	200	—
21	B21P-SHF-1AA	BS21P-SHF-1AA	—	50.0(1.969)	250	200	—
22	B22P-SHF-1AA	BS22P-SHF-1AA	—	52.5(2.067)	250	200	—
24	B24P-SHF-1AA	BS24P-SHF-1AA	—	57.5(2.264)	250	200	—
25	B25P-SHF-1AA	BS25P-SHF-1AA	—	60.0(2.362)	250	200	—

Material and Finish

Post: Brass copper-undercoated, tin/lead-plated
 Wafer: Nylon 66, UL94V-0, natural (white) for the top and side entry types
 Nylon 6, UL94V-0, natural (white) for the bottom entry type

<For reference> As the color identification, the following alphabet shall be put in the underlined part.
 For availability, delivery and minimum order quantity, contact JST.

ex. B3P-SHF-1AA-oo
 (blank)...natural (white)
 BK...black R...red TR...tomato red E...blue M...green
 O...orange N...brown

NH CONNECTOR

PC board layout (viewed from soldering side) and Assembly layout

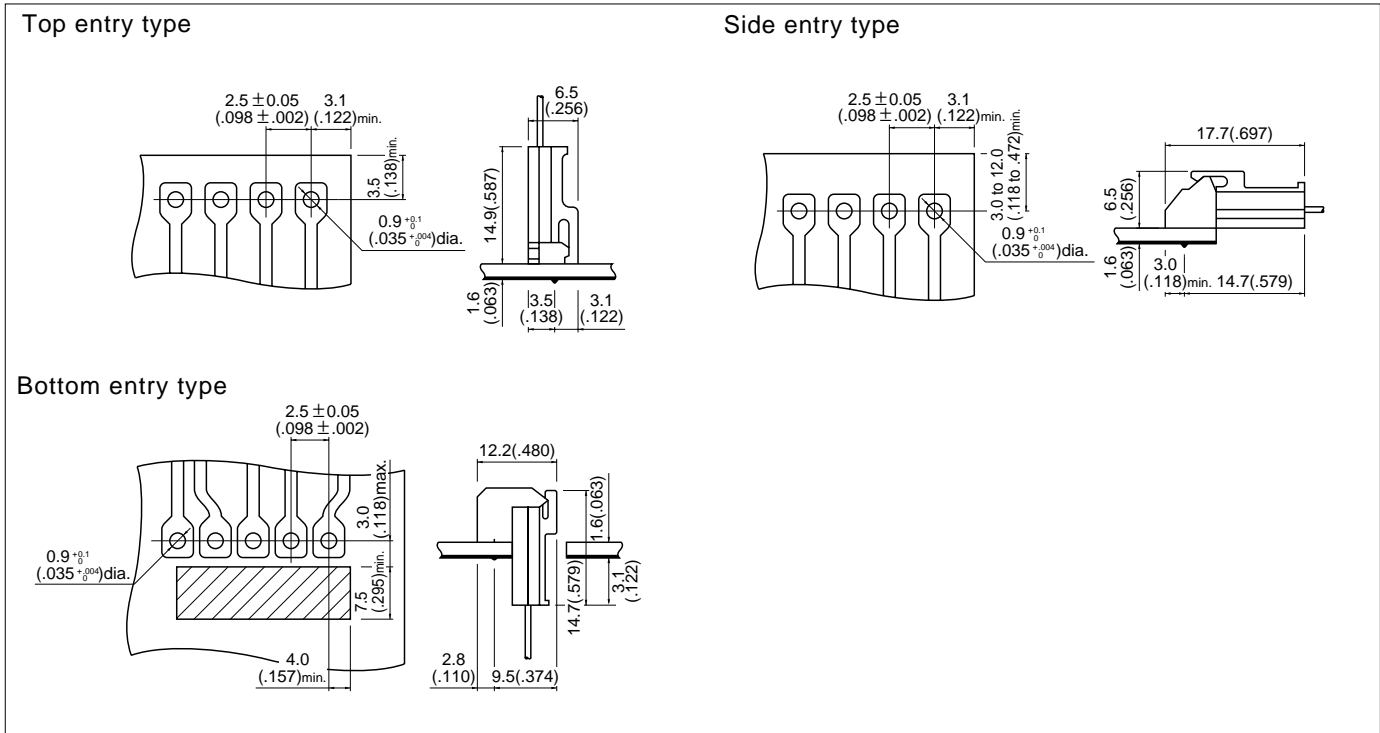

Note:

1. Tolerances are non-cumulative: $\pm 0.05\text{mm}(\pm .002")$ for all centers.
2. Hole dimensions differ according to the kind of PC board and piercing method. The dimensions above should serve as a guideline. Contact JST for details.

Applicator for the semi-automatic press AP-K2N

Contact	Crimp applicator MKS-L		Compact crimp applicator MKS-LS		Strip-crimp applicator MKS-SC
	with safety cover	without safety cover	with safety cover	without safety cover	with safety cover
SHF-001T-0.8BS	APLMK SHF001-08S	APLNC SHF001-08S	APLMKLS SHF001-08S	APLLSNC SHF001-08S	APLSC SHF001-08S
SHF-002T-0.8BS	APLMK SHF002-08S	APLNC SHF002-08S	APLMKLS SHF002-08S	APLLSNC SHF002-08S	APLSC SHF002-08S